

- Notes:**
1. This is not a construction drawing and is intended for illustrative purposes only.
 2. White lining is indicative only.

- Legend:**
- Red Line
 - Detailed Junction within the Outline Planning Application Boundary
 - DBC Boundary

LOCATION PLAN
Scale N.T.S.

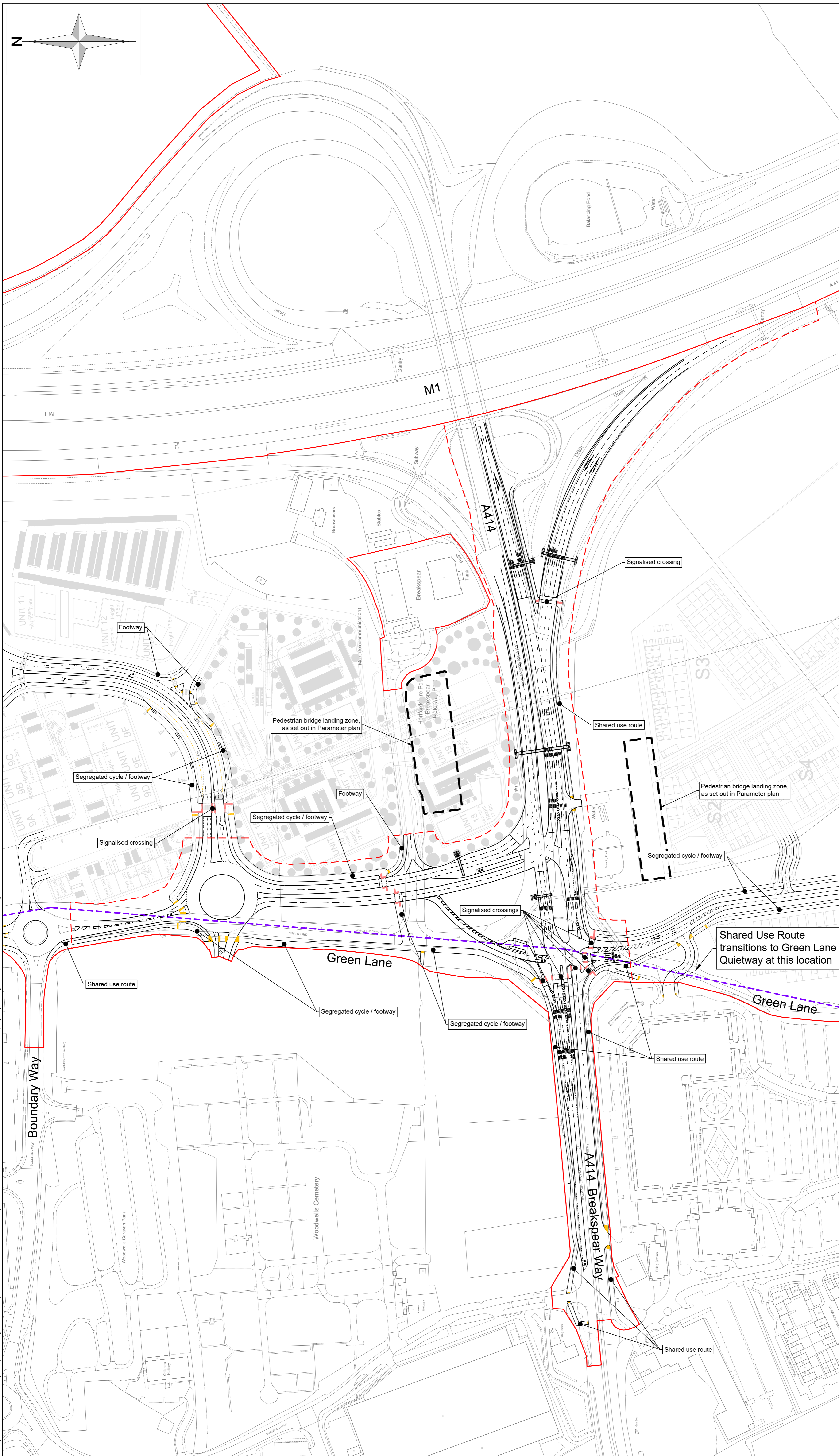
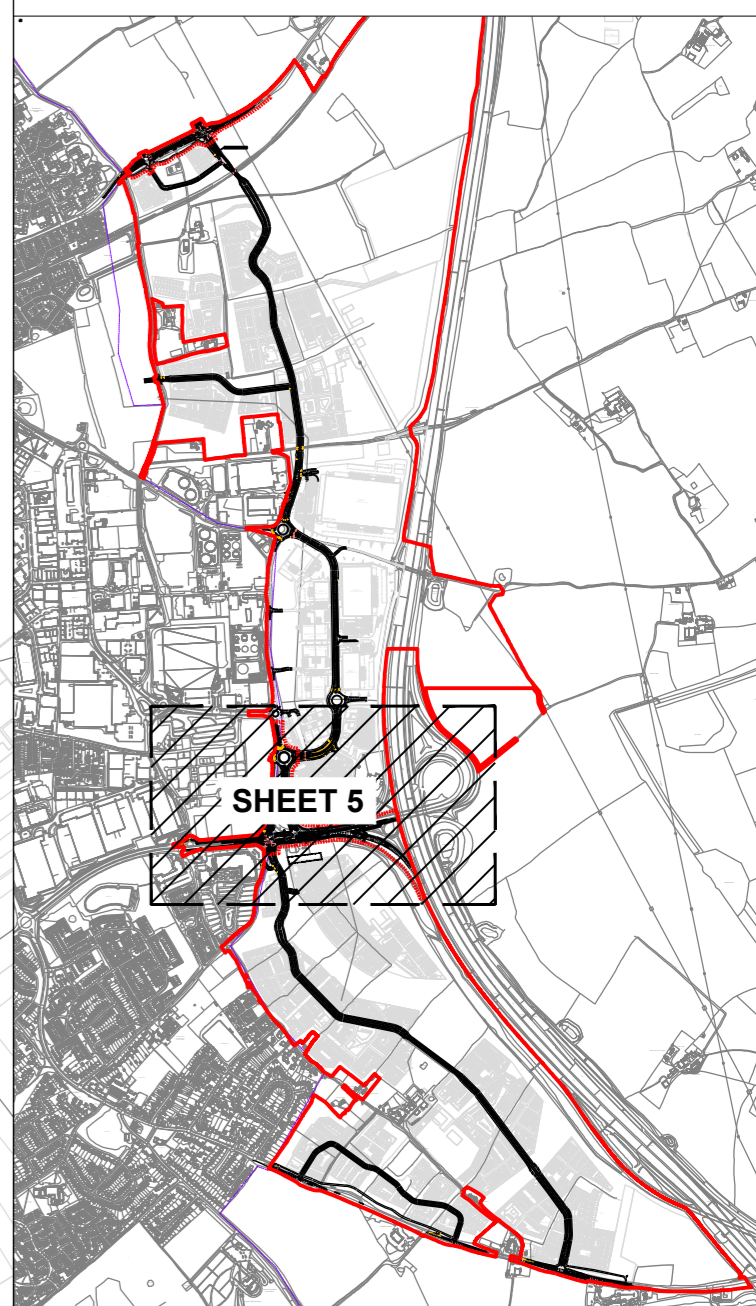

Rev	Amendments	Date	By	Chk	Auth
P9	Updated RLB	21.11.25	JM	MDC	MDC
P8	Updated highways layout & RLB	31.10.25	JB	NL	IMDC
P7	Redline updated.	17.10.25	JM	MDC	MDC
P6	Road names added.	08.09.25	JM	MDC	MDC
P5	David Lock comments.	29.08.25	JM	MDC	MDC
P4	Drawing title & key amended. Labels & road names added.	22.08.25	NS	MDC	MDC
P3	Active travel mods south of junction. Red Line shown in Key.	24.06.25	JM	MDC	MDC
P2	Mods to footpath adjacent to Prologis Park. Mods to western arm of junction, on and off carriageway.	24.06.25	JM	MDC	MDC

vectos. PART OF **SLR**

www.slrconsulting.com

FOR SUBMISSION

Client: **The Crown Estate**

Project: **East Hemel Hempstead**

Drawing Title: **INDICATIVE PRIMARY HIGHWAYS ARRANGEMENTS WITHIN THE DEVELOPMENT AREA - LARGER SCALE PLAN - SHEET 5**

Scale: **1:1500 @ A1** SLR Project No: **131121**

Designed	Drawn	Checked	Authorised
	JM	MDC	
Date	Date	Date	Date
	21.04.2025	21.04.2025	

Drawing Number: **EHUK-VEC-ZZZ-XXX-DR-CR-00010.5** Rev: **P9**

C:\Users\james.mason\SLR Consulting\Transport Planning Associates Projects - Documents\131121 - Cornhambury Estate\DRAWINGS\EHUK-VEC-ZZZ-XXX-DR-CR-00010-F18 - Indicative Primary Highways Arrangements within the Development Area.dwg 21/11/2025