















NO.	DESCRIPTION	DATE	BY	REVISION
1	ISSUED FOR TENDERS	15/01/2024	AS	AS
2	ISSUED FOR TENDERS	15/01/2024	AS	AS
3	ISSUED FOR TENDERS	15/01/2024	AS	AS
4	ISSUED FOR TENDERS	15/01/2024	AS	AS
5	ISSUED FOR TENDERS	15/01/2024	AS	AS

**DETECTION METHOD**  
IN ACCORDANCE WITH PAS 128:2014 SURVEY TYPE B

**Drainage Survey**  
All accessible Manholes and Inspection chambers have had their respective covers lifted with pipe sizes, inverts, chamber sizes and service data recorded from ground level. All connections from GPs, Outlets, Drains, VPs, RE's and manholes have been proven wherever possible using suitable connections (AC) and/or sonde instrumentation where applicable. Where these methods have proved unsuccessful then assumed (AR) straight line connections will be shown.

**Electricity**  
Electric cables will have been predominantly located using EML methodology with electronically derived depths shown. GPR techniques will be employed to achieve greater quality levels as required.

**BT Cables**  
BT cables will have been predominantly located using EML methodology with electronically derived depths shown. GPR techniques will be employed to achieve greater quality levels as required. Due to current laws and legislation protecting all BT services, cabling can only be located remotely. We therefore compare all our telecom findings against record information to produce the final service layout. In some instances, where high amount of cable ducts are present, we may only be able to identify a linear centre peak signal rather than identifying all the individual duct positions. For further information regarding Telecoms apparatus, please contact Openreach directly.

**Cable TV & Coax**  
Cable TV and Coax cables will have been predominantly located using EML methodology with electronically derived depths shown. GPR techniques will be employed to achieve greater quality levels as required.

**Fire Cables**  
Fire cables will have been predominantly located using GPR methodology. This is due to the materials used within fibre optic cabling. In some rare instances, tracer cabling or conductive non fibre optic cabling will be present within some or all ducting. When this is the case, both EML and GPR methodology will be combined to identify service network and achieve greater quality levels.

**LC, TS and/or Sec cables**  
LC, TS and/or Sec cables will have been predominantly located using EML methodology with electronically derived depths shown. GPR techniques will be employed to achieve greater quality levels as required.

**Water Inc. Fuel Pipes and Hot Water Pipes**  
CMAA and/or WMMV pipe work will have been attempted and located using both EML & GPR methodology with electronically derived depths shown for the former and depths to crown levels shown for the latter. When the Gas/Water pipe work is constructed using conductive materials, then we are able to employ multiple geophysical techniques to identify service networks and achieve greater quality levels. Where a non conductive material is used, GPR methodology will be employed to locate and plot the final service layout.

**Ground Penetrating Radar**  
GPR methodology is used to identify and locate all non metallic, non conductive piping and cabling. We also employ GPR to obtain a greater accuracy levels on EML located services. The GPR has a greater accuracy rate on pipe or service diameter upward of 200mm GSDmm, as size increments increase, so does the chance of detection. The GPR can produce varying results and as such, would not be used as an independent utility surveying instrument.

**Unidentified Traces**  
All UTI will have been predominantly located using EML methodology with electronically derived depths shown. GPR techniques will be employed to achieve greater quality levels as required. Every effort has been made to identify the service but in this instance, it is not achievable. We recommend excavation work to determine identity and depth where applicable.

**Scanning (DL-C)**  
Scanning has been identified on site with a potential of an undetectable service present.

**Assumed routes & Section Through the Site**  
Assumed routes (AR) are shown if there is evidence that a service exists but we are unable to trace it whilst on site. The surveyor will attempt to locate various manholes/manholes (service evidence) etc. around site area to successfully determine an assumed route between these points. If there is little evidence on site but they believe a service is still present, then a common sense approach to an assumed route shall be employed.

**Taken from records (TFR)**  
TFR are service routes that are taken from STAT record plans or previous survey information and overlaid onto our drawings.

**SURVEY RECOMMENDATIONS**

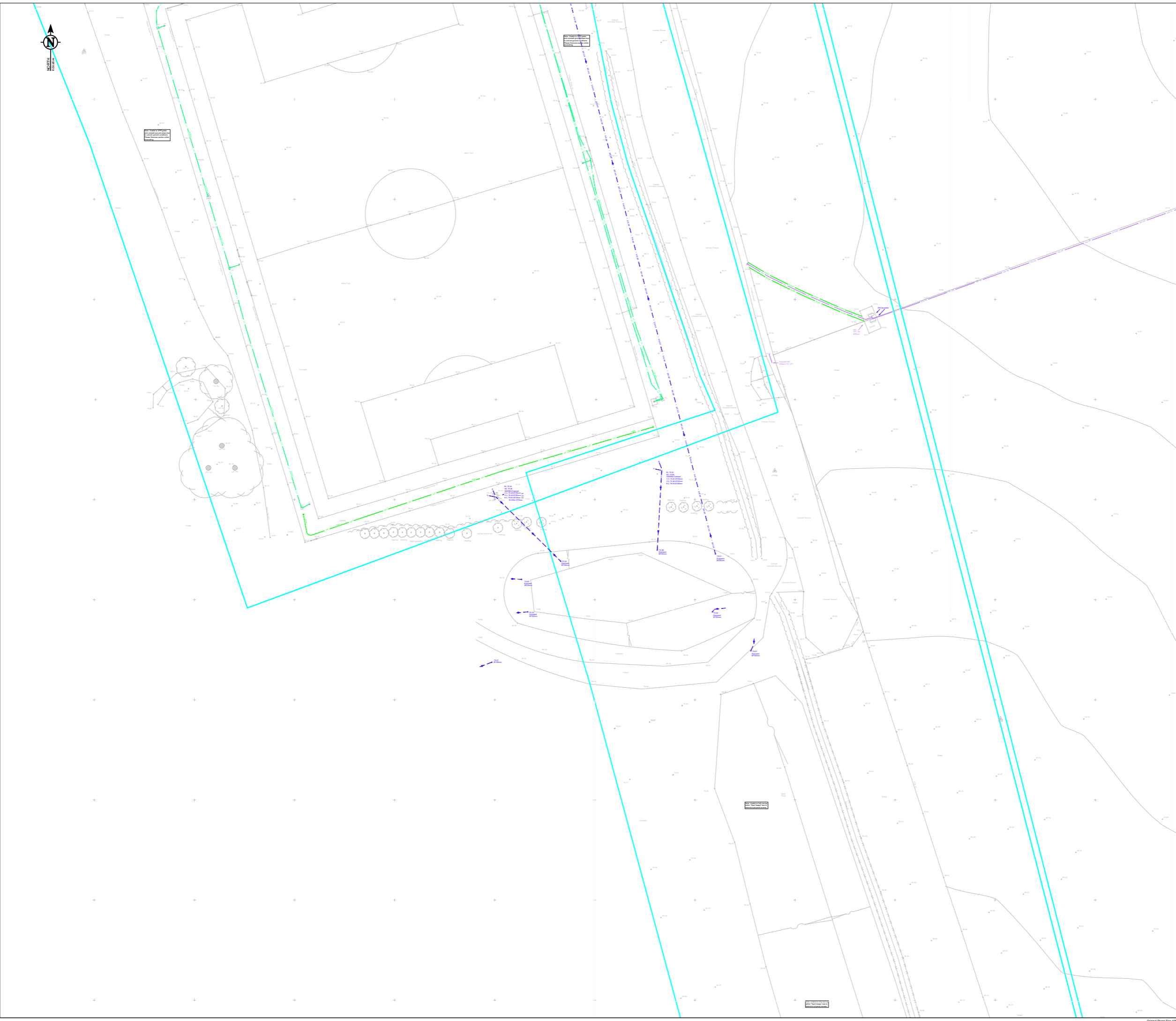

**UTILITIES & UNDERGROUND INVESTIGATIONS**

ABBREVIATIONS & SYMBOLS	ABBREVIATIONS & SYMBOLS	ABBREVIATIONS & SYMBOLS
BT DC 1 (Duct) Cable	BT DC 2 (Duct) Cable	BT DC 3 (Duct) Cable
BT DC 4 (Duct) Cable	BT DC 5 (Duct) Cable	BT DC 6 (Duct) Cable
BT DC 7 (Duct) Cable	BT DC 8 (Duct) Cable	BT DC 9 (Duct) Cable
BT DC 10 (Duct) Cable	BT DC 11 (Duct) Cable	BT DC 12 (Duct) Cable
BT DC 13 (Duct) Cable	BT DC 14 (Duct) Cable	BT DC 15 (Duct) Cable
BT DC 16 (Duct) Cable	BT DC 17 (Duct) Cable	BT DC 18 (Duct) Cable
BT DC 19 (Duct) Cable	BT DC 20 (Duct) Cable	BT DC 21 (Duct) Cable
BT DC 22 (Duct) Cable	BT DC 23 (Duct) Cable	BT DC 24 (Duct) Cable
BT DC 25 (Duct) Cable	BT DC 26 (Duct) Cable	BT DC 27 (Duct) Cable
BT DC 28 (Duct) Cable	BT DC 29 (Duct) Cable	BT DC 30 (Duct) Cable
BT DC 31 (Duct) Cable	BT DC 32 (Duct) Cable	BT DC 33 (Duct) Cable
BT DC 34 (Duct) Cable	BT DC 35 (Duct) Cable	BT DC 36 (Duct) Cable
BT DC 37 (Duct) Cable	BT DC 38 (Duct) Cable	BT DC 39 (Duct) Cable
BT DC 40 (Duct) Cable	BT DC 41 (Duct) Cable	BT DC 42 (Duct) Cable
BT DC 43 (Duct) Cable	BT DC 44 (Duct) Cable	BT DC 45 (Duct) Cable
BT DC 46 (Duct) Cable	BT DC 47 (Duct) Cable	BT DC 48 (Duct) Cable
BT DC 49 (Duct) Cable	BT DC 50 (Duct) Cable	BT DC 51 (Duct) Cable
BT DC 52 (Duct) Cable	BT DC 53 (Duct) Cable	BT DC 54 (Duct) Cable
BT DC 55 (Duct) Cable	BT DC 56 (Duct) Cable	BT DC 57 (Duct) Cable
BT DC 58 (Duct) Cable	BT DC 59 (Duct) Cable	BT DC 60 (Duct) Cable
BT DC 61 (Duct) Cable	BT DC 62 (Duct) Cable	BT DC 63 (Duct) Cable
BT DC 64 (Duct) Cable	BT DC 65 (Duct) Cable	BT DC 66 (Duct) Cable
BT DC 67 (Duct) Cable	BT DC 68 (Duct) Cable	BT DC 69 (Duct) Cable
BT DC 70 (Duct) Cable	BT DC 71 (Duct) Cable	BT DC 72 (Duct) Cable
BT DC 73 (Duct) Cable	BT DC 74 (Duct) Cable	BT DC 75 (Duct) Cable
BT DC 76 (Duct) Cable	BT DC 77 (Duct) Cable	BT DC 78 (Duct) Cable
BT DC 79 (Duct) Cable	BT DC 80 (Duct) Cable	BT DC 81 (Duct) Cable
BT DC 82 (Duct) Cable	BT DC 83 (Duct) Cable	BT DC 84 (Duct) Cable
BT DC 85 (Duct) Cable	BT DC 86 (Duct) Cable	BT DC 87 (Duct) Cable
BT DC 88 (Duct) Cable	BT DC 89 (Duct) Cable	BT DC 90 (Duct) Cable
BT DC 91 (Duct) Cable	BT DC 92 (Duct) Cable	BT DC 93 (Duct) Cable
BT DC 94 (Duct) Cable	BT DC 95 (Duct) Cable	BT DC 96 (Duct) Cable
BT DC 97 (Duct) Cable	BT DC 98 (Duct) Cable	BT DC 99 (Duct) Cable
BT DC 100 (Duct) Cable	BT DC 101 (Duct) Cable	BT DC 102 (Duct) Cable
BT DC 103 (Duct) Cable	BT DC 104 (Duct) Cable	BT DC 105 (Duct) Cable
BT DC 106 (Duct) Cable	BT DC 107 (Duct) Cable	BT DC 108 (Duct) Cable
BT DC 109 (Duct) Cable	BT DC 110 (Duct) Cable	BT DC 111 (Duct) Cable
BT DC 112 (Duct) Cable	BT DC 113 (Duct) Cable	BT DC 114 (Duct) Cable
BT DC 115 (Duct) Cable	BT DC 116 (Duct) Cable	BT DC 117 (Duct) Cable
BT DC 118 (Duct) Cable	BT DC 119 (Duct) Cable	BT DC 120 (Duct) Cable
BT DC 121 (Duct) Cable	BT DC 122 (Duct) Cable	BT DC 123 (Duct) Cable
BT DC 124 (Duct) Cable	BT DC 125 (Duct) Cable	BT DC 126 (Duct) Cable
BT DC 127 (Duct) Cable	BT DC 128 (Duct) Cable	BT DC 129 (Duct) Cable
BT DC 130 (Duct) Cable	BT DC 131 (Duct) Cable	BT DC 132 (Duct) Cable
BT DC 133 (Duct) Cable	BT DC 134 (Duct) Cable	BT DC 135 (Duct) Cable
BT DC 136 (Duct) Cable	BT DC 137 (Duct) Cable	BT DC 138 (Duct) Cable
BT DC 139 (Duct) Cable	BT DC 140 (Duct) Cable	BT DC 141 (Duct) Cable
BT DC 142 (Duct) Cable	BT DC 143 (Duct) Cable	BT DC 144 (Duct) Cable
BT DC 145 (Duct) Cable	BT DC 146 (Duct) Cable	BT DC 147 (Duct) Cable
BT DC 148 (Duct) Cable	BT DC 149 (Duct) Cable	BT DC 150 (Duct) Cable
BT DC 151 (Duct) Cable	BT DC 152 (Duct) Cable	BT DC 153 (Duct) Cable
BT DC 154 (Duct) Cable	BT DC 155 (Duct) Cable	BT DC 156 (Duct) Cable
BT DC 157 (Duct) Cable	BT DC 158 (Duct) Cable	BT DC 159 (Duct) Cable
BT DC 160 (Duct) Cable	BT DC 161 (Duct) Cable	BT DC 162 (Duct) Cable
BT DC 163 (Duct) Cable	BT DC 164 (Duct) Cable	BT DC 165 (Duct) Cable
BT DC 166 (Duct) Cable	BT DC 167 (Duct) Cable	BT DC 168 (Duct) Cable
BT DC 169 (Duct) Cable	BT DC 170 (Duct) Cable	BT DC 171 (Duct) Cable
BT DC 172 (Duct) Cable	BT DC 173 (Duct) Cable	BT DC 174 (Duct) Cable
BT DC 175 (Duct) Cable	BT DC 176 (Duct) Cable	BT DC 177 (Duct) Cable
BT DC 178 (Duct) Cable	BT DC 179 (Duct) Cable	BT DC 180 (Duct) Cable
BT DC 181 (Duct) Cable	BT DC 182 (Duct) Cable	BT DC 183 (Duct) Cable
BT DC 184 (Duct) Cable	BT DC 185 (Duct) Cable	BT DC 186 (Duct) Cable
BT DC 187 (Duct) Cable	BT DC 188 (Duct) Cable	BT DC 189 (Duct) Cable
BT DC 190 (Duct) Cable	BT DC 191 (Duct) Cable	BT DC 192 (Duct) Cable
BT DC 193 (Duct) Cable	BT DC 194 (Duct) Cable	BT DC 195 (Duct) Cable
BT DC 196 (Duct) Cable	BT DC 197 (Duct) Cable	BT DC 198 (Duct) Cable
BT DC 199 (Duct) Cable	BT DC 200 (Duct) Cable	BT DC 201 (Duct) Cable
BT DC 202 (Duct) Cable	BT DC 203 (Duct) Cable	BT DC 204 (Duct) Cable
BT DC 205 (Duct) Cable	BT DC 206 (Duct) Cable	BT DC 207 (Duct) Cable
BT DC 208 (Duct) Cable	BT DC 209 (Duct) Cable	BT DC 210 (Duct) Cable
BT DC 211 (Duct) Cable	BT DC 212 (Duct) Cable	BT DC 213 (Duct) Cable
BT DC 214 (Duct) Cable	BT DC 215 (Duct) Cable	BT DC 216 (Duct) Cable
BT DC 217 (Duct) Cable	BT DC 218 (Duct) Cable	BT DC 219 (Duct) Cable
BT DC 220 (Duct) Cable	BT DC 221 (Duct) Cable	BT DC 222 (Duct) Cable
BT DC 223 (Duct) Cable	BT DC 224 (Duct) Cable	BT DC 225 (Duct) Cable
BT DC 226 (Duct) Cable	BT DC 227 (Duct) Cable	BT DC 228 (Duct) Cable
BT DC 229 (Duct) Cable	BT DC 230 (Duct) Cable	BT DC 231 (Duct) Cable
BT DC 232 (Duct) Cable	BT DC 233 (Duct) Cable	BT DC 234 (Duct) Cable
BT DC 235 (Duct) Cable	BT DC 236 (Duct) Cable	BT DC 237 (Duct) Cable
BT DC 238 (Duct) Cable	BT DC 239 (Duct) Cable	BT DC 240 (Duct) Cable
BT DC 241 (Duct) Cable	BT DC 242 (Duct) Cable	BT DC 243 (Duct) Cable
BT DC 244 (Duct) Cable	BT DC 245 (Duct) Cable	BT DC 246 (Duct) Cable
BT DC 247 (Duct) Cable	BT DC 248 (Duct) Cable	BT DC 249 (Duct) Cable
BT DC 250 (Duct) Cable	BT DC 251 (Duct) Cable	BT DC 252 (Duct) Cable
BT DC 253 (Duct) Cable	BT DC 254 (Duct) Cable	BT DC 255 (Duct) Cable
BT DC 256 (Duct) Cable	BT DC 257 (Duct) Cable	BT DC 258 (Duct) Cable
BT DC 259 (Duct) Cable	BT DC 260 (Duct) Cable	BT DC 261 (Duct) Cable
BT DC 262 (Duct) Cable	BT DC 263 (Duct) Cable	BT DC 264 (Duct) Cable
BT DC 265 (Duct) Cable	BT DC 266 (Duct) Cable	BT DC 267 (Duct) Cable
BT DC 268 (Duct) Cable	BT DC 269 (Duct) Cable	BT DC 270 (Duct) Cable
BT DC 271 (Duct) Cable	BT DC 272 (Duct) Cable	BT DC 273 (Duct) Cable
BT DC 274 (Duct) Cable	BT DC 275 (Duct) Cable	BT DC 276 (Duct) Cable
BT DC 277 (Duct) Cable	BT DC 278 (Duct) Cable	BT DC 279 (Duct) Cable
BT DC 280 (Duct) Cable	BT DC 281 (Duct) Cable	BT DC 282 (Duct) Cable
BT DC 283 (Duct) Cable	BT DC 284 (Duct) Cable	BT DC 285 (Duct) Cable
BT DC 286 (Duct) Cable	BT DC 287 (Duct) Cable	BT DC 288 (Duct) Cable
BT DC 289 (Duct) Cable	BT DC 290 (Duct) Cable	BT DC 291 (Duct) Cable
BT DC 292 (Duct) Cable	BT DC 293 (Duct) Cable	BT DC 294 (Duct) Cable
BT DC 295 (Duct) Cable	BT DC 296 (Duct) Cable	BT DC 297 (Duct) Cable
BT DC 298 (Duct) Cable	BT DC 299 (Duct) Cable	BT DC 300 (Duct) Cable
BT DC 301 (Duct) Cable	BT DC 302 (Duct) Cable	BT DC 303 (Duct) Cable
BT DC 304 (Duct) Cable	BT DC 305 (Duct) Cable	BT DC 306 (Duct) Cable
BT DC 307 (Duct) Cable	BT DC 308 (Duct) Cable	BT DC 309 (Duct) Cable
BT DC 310 (Duct) Cable	BT DC 311 (Duct) Cable	BT DC 312 (Duct) Cable
BT DC 313 (Duct) Cable	BT DC 314 (Duct) Cable	BT DC 315 (Duct) Cable
BT DC 316 (Duct) Cable	BT DC 317 (Duct) Cable	BT DC 318 (Duct) Cable
BT DC 319 (Duct) Cable	BT DC 320 (Duct) Cable	BT DC 321 (Duct) Cable
BT DC 322 (Duct) Cable	BT DC 323 (Duct) Cable	BT DC 324 (Duct) Cable
BT DC 325 (Duct) Cable	BT DC 326 (Duct) Cable	BT DC 327 (Duct) Cable
BT DC 328 (Duct) Cable	BT DC 329 (Duct) Cable	BT DC 330 (Duct) Cable
BT DC 331 (Duct) Cable	BT DC 332 (Duct) Cable	BT DC 333 (Duct) Cable
BT DC 334 (Duct) Cable	BT DC 335 (Duct) Cable	BT DC 336 (Duct) Cable
BT DC 337 (Duct) Cable	BT DC 338 (Duct) Cable	BT DC 339 (Duct) Cable
BT DC 340 (Duct) Cable	BT DC 341 (Duct) Cable	BT DC 342 (Duct) Cable
BT DC 343 (Duct) Cable	BT DC 344 (Duct) Cable	BT DC 345 (Duct) Cable
BT DC 346 (Duct) Cable	BT DC 347 (Duct) Cable	BT DC 348 (Duct) Cable
BT DC 349 (Duct) Cable	BT DC 350 (Duct) Cable	BT DC 351 (Duct) Cable
BT DC 352 (Duct) Cable	BT DC 353 (Duct) Cable	BT DC 354 (Duct) Cable
BT DC 355 (Duct) Cable	BT DC 356 (Duct) Cable	BT DC 357 (Duct) Cable
BT DC 358 (Duct) Cable	BT DC 359 (Duct) Cable	BT DC 360 (Duct) Cable
BT DC 361 (Duct) Cable	BT DC 362 (Duct) Cable	BT DC 363 (Duct) Cable
BT DC 364 (Duct) Cable	BT DC 365 (Duct) Cable	BT DC 366 (Duct) Cable
BT DC 367 (Duct) Cable	BT DC 368 (Duct) Cable	BT DC 369 (Duct) Cable
BT DC 370 (Duct) Cable	BT DC 371 (Duct) Cable	BT DC 372 (Duct) Cable
BT DC 373 (Duct) Cable	BT DC 374 (Duct) Cable	BT DC 375 (Duct) Cable
BT DC 376 (Duct) Cable	BT DC 377 (Duct) Cable	BT DC 378 (Duct) Cable
BT DC 379 (Duct) Cable	BT DC 380 (Duct) Cable	BT DC 381 (Duct) Cable
BT DC 382 (Duct) Cable	BT DC 383 (Duct) Cable	BT DC 384 (Duct) Cable
BT DC 385 (Duct) Cable	BT DC 386 (Duct) Cable	BT DC 387 (Duct) Cable
BT DC 388 (Duct) Cable	BT DC 389 (Duct) Cable	BT DC 390 (Duct) Cable
BT DC 391 (Duct) Cable	BT DC 392 (Duct) Cable	BT DC 393 (Duct) Cable
BT DC 394 (Duct) Cable	BT DC 395 (Duct) Cable	BT DC 396 (Duct) Cable
BT DC 397 (Duct) Cable	BT DC 398 (Duct) Cable	BT DC 399 (Duct) Cable
BT DC 400 (Duct) Cable	BT DC 401 (Duct) Cable	BT DC 402 (Duct) Cable
BT DC 403 (Duct) Cable	BT DC 404 (Duct) Cable	BT DC 405 (Duct) Cable
BT DC 406 (Duct) Cable	BT DC 407 (Duct) Cable	BT DC 408 (Duct) Cable
BT DC 409 (Duct) Cable	BT DC 410 (Duct) Cable	BT DC 411 (Duct) Cable
BT DC 412 (Duct) Cable	BT DC 413 (Duct) Cable	BT DC 414 (Duct) Cable
BT DC 415 (Duct) Cable	BT DC 416 (Duct) Cable	BT DC 417 (Duct) Cable
BT DC 418 (Duct) Cable	BT DC 419 (Duct) Cable	BT DC 420 (Duct) Cable
BT DC 421 (Duct) Cable	BT DC 422 (Duct) Cable	BT DC 423 (Duct) Cable
BT DC 424 (Duct) Cable	BT DC 425 (Duct) Cable	BT DC 426 (Duct) Cable
BT DC 427 (Duct) Cable	BT DC 428 (Duct) Cable	BT DC 429 (Duct) Cable
BT DC 430 (Duct) Cable	BT DC 431 (Duct) Cable	BT DC 432 (Duct) Cable
BT DC 433 (Duct) Cable	BT DC 434 (Duct) Cable	BT DC 435 (Duct) Cable
BT DC 436 (Duct) Cable	BT DC 437 (Duct) Cable	BT DC 438 (Duct) Cable
BT DC 439 (Duct) Cable	BT DC 440 (Duct) Cable	BT DC 441 (Duct) Cable
BT DC 442 (Duct) Cable	BT DC 443 (Duct) Cable	BT DC 444 (Duct) Cable
BT DC 445 (Duct) Cable	BT DC 446 (Duct) Cable	BT DC 447 (Duct) Cable
BT DC 448 (Duct) Cable	BT DC 449 (Duct) Cable	BT DC 450 (Duct) Cable
BT DC 451 (Duct) Cable	BT DC 452 (Duct) Cable	BT DC 453 (Duct) Cable
BT DC 454 (Duct) Cable	BT DC 455 (Duct) Cable	BT DC 456 (Duct) Cable
BT DC 457 (Duct) Cable	BT DC 458 (Duct) Cable	BT DC 459 (Duct) Cable
BT DC 460 (Duct) Cable	BT DC 461 (Duct) Cable	BT DC 462 (Duct) Cable
BT DC 463 (Duct) Cable	BT DC 464 (Duct) Cable	BT DC 465 (Duct) Cable
BT DC 466 (Duct) Cable	BT DC 467 (Duct) Cable	BT DC 468 (Duct) Cable
BT DC 469 (Duct) Cable	BT DC 470 (Duct) Cable	BT DC 471 (Duct) Cable
BT DC 472 (Duct) Cable	BT DC 473 (Duct) Cable	BT DC 474 (Duct) Cable
BT DC 475 (Duct) Cable	BT DC 476 (Duct) Cable	BT DC 477 (Duct) Cable
BT DC 478 (Duct) Cable	BT DC 479 (Duct) Cable	BT DC 480 (Duct) Cable
BT DC 481 (Duct) Cable	BT DC 482 (Duct) Cable	BT DC 483 (Duct) Cable
BT DC 484 (Duct) Cable	BT DC 485 (Duct) Cable	BT DC 486 (Duct) Cable
BT DC 487 (Duct) Cable	BT DC 488 (Duct) Cable	BT DC 489 (Duct) Cable
BT DC 490 (Duct) Cable	BT DC 491 (Duct) Cable	BT DC 492 (Duct) Cable
BT DC 493 (Duct) Cable	BT DC 494 (Duct) Cable	BT DC 495 (Duct) Cable
BT DC 496 (Duct) Cable	BT DC 497 (Duct) Cable	BT DC 498 (Duct) Cable
BT DC 499 (Duct) Cable	BT DC 500 (Duct) Cable	BT DC 501 (Duct) Cable
BT DC 502 (Duct) Cable	BT DC 503 (Duct) Cable	BT DC 504 (Duct) Cable
BT DC 505 (Duct) Cable	BT DC 506 (Duct) Cable	BT DC 507 (Duct) Cable
BT DC 508 (Duct) Cable	BT DC 509 (Duct) Cable	BT DC 510 (Duct) Cable
BT DC 511 (Duct) Cable	BT DC 512 (Duct) Cable	BT DC 513 (Duct) Cable
BT DC 514 (Duct) Cable	BT DC 515 (Duct) Cable	BT DC 516 (Duct) Cable
BT DC 517 (Duct) Cable	BT DC 518 (Duct) Cable	BT DC 519 (Duct) Cable
BT DC 520 (Duct) Cable	BT DC 521 (Duct) Cable	BT DC 522 (Duct) Cable
BT DC 523 (Duct) Cable	BT DC 524 (Duct) Cable	BT DC 525 (Duct) Cable
BT DC 526 (Duct) Cable	BT DC 527 (Duct) Cable	BT DC 528 (Duct) Cable
BT DC 529 (Duct) Cable	BT DC 530 (Duct) Cable	BT DC 531 (Duct) Cable
BT DC 532 (Duct) Cable	BT DC 533 (Duct) Cable	BT DC 534 (Duct) Cable
BT DC 535 (Duct) Cable	BT DC 536 (Duct) Cable	BT DC 537 (Duct) Cable
BT DC 538 (Duct) Cable	BT DC 539 (Duct) Cable	BT DC 540 (Duct) Cable
BT DC 541 (Duct) Cable	BT DC 542 (Duct) Cable	BT DC 543 (Duct) Cable



