

- NOTES**
1. THE HIGHWAY AUTHORITY IS HERTFORDSHIRE COUNTY COUNCIL EXCEPT FOR THE M1 SLIP ROADS WHERE NATIONAL HIGHWAYS ARE THE HIGHWAY AUTHORITY.
 2. ANY DISCREPANCIES ON SITE MUST BE REPORTED TO THE PROJECT MANAGER IMMEDIATELY.
 3. ALL WORKS ARE TO BE CARRIED OUT IN ACCORDANCE WITH THE APPROVED CONTRACT DRAWINGS WITHIN APPENDIX 0/4, THE ROADS IN HERTFORDSHIRE: HIGHWAY DESIGN GUIDE AND THE MANUAL OF CONTRACT DOCUMENTS FOR HIGHWAY WORKS (SHW) VOLUME 1 AND SPECIFICATION APPENDICES.

- KEY**
- PLANNING REDLINE BOUNDARY
 - - - DETAILED JUNCTION WITH THE OUTLINE PLANNING APPLICATION BOUNDARY

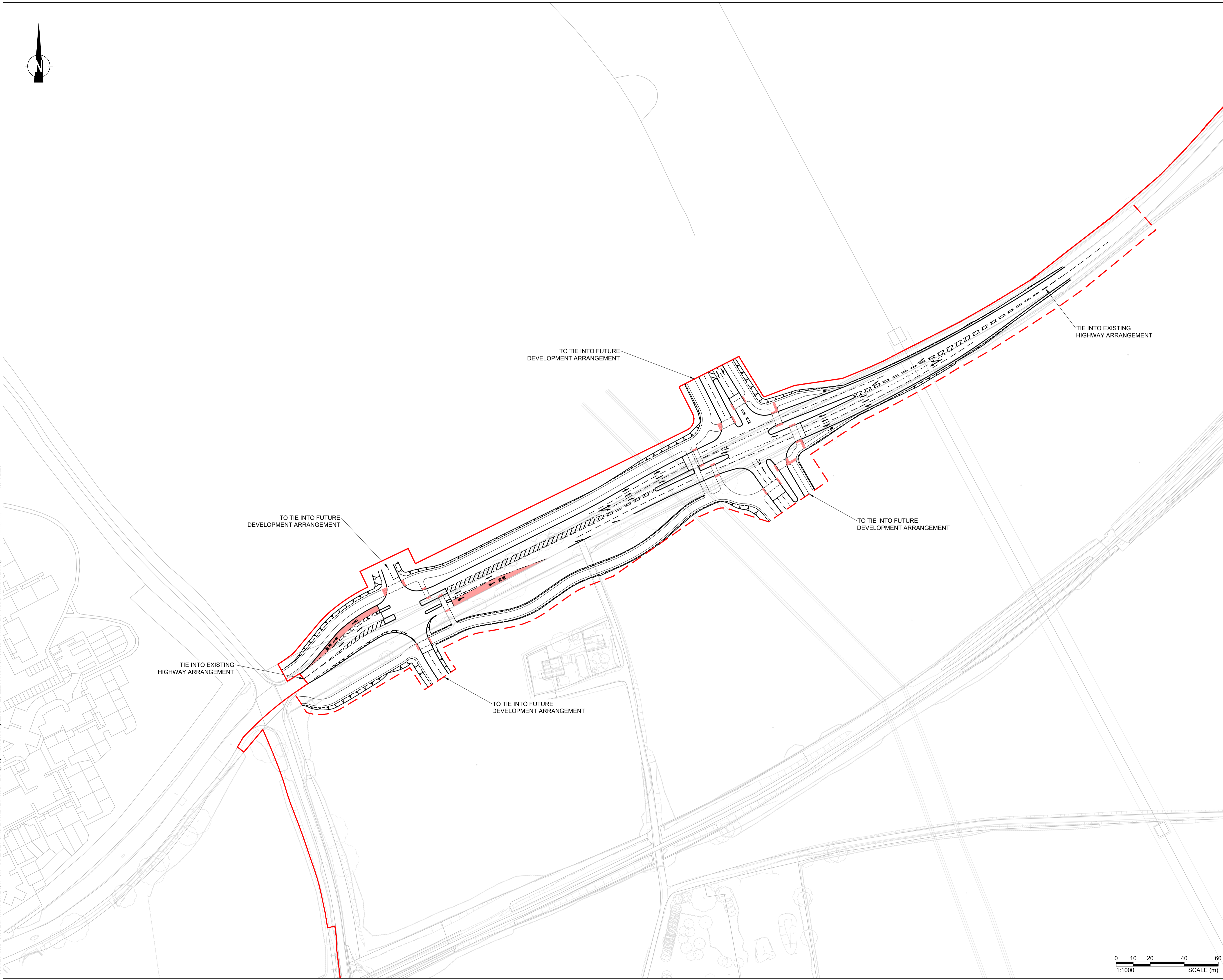

P01	FIRST ISSUE	24.10.25	JB	NL	AB
Rev	Amendments	Date	By	Chk	Auth

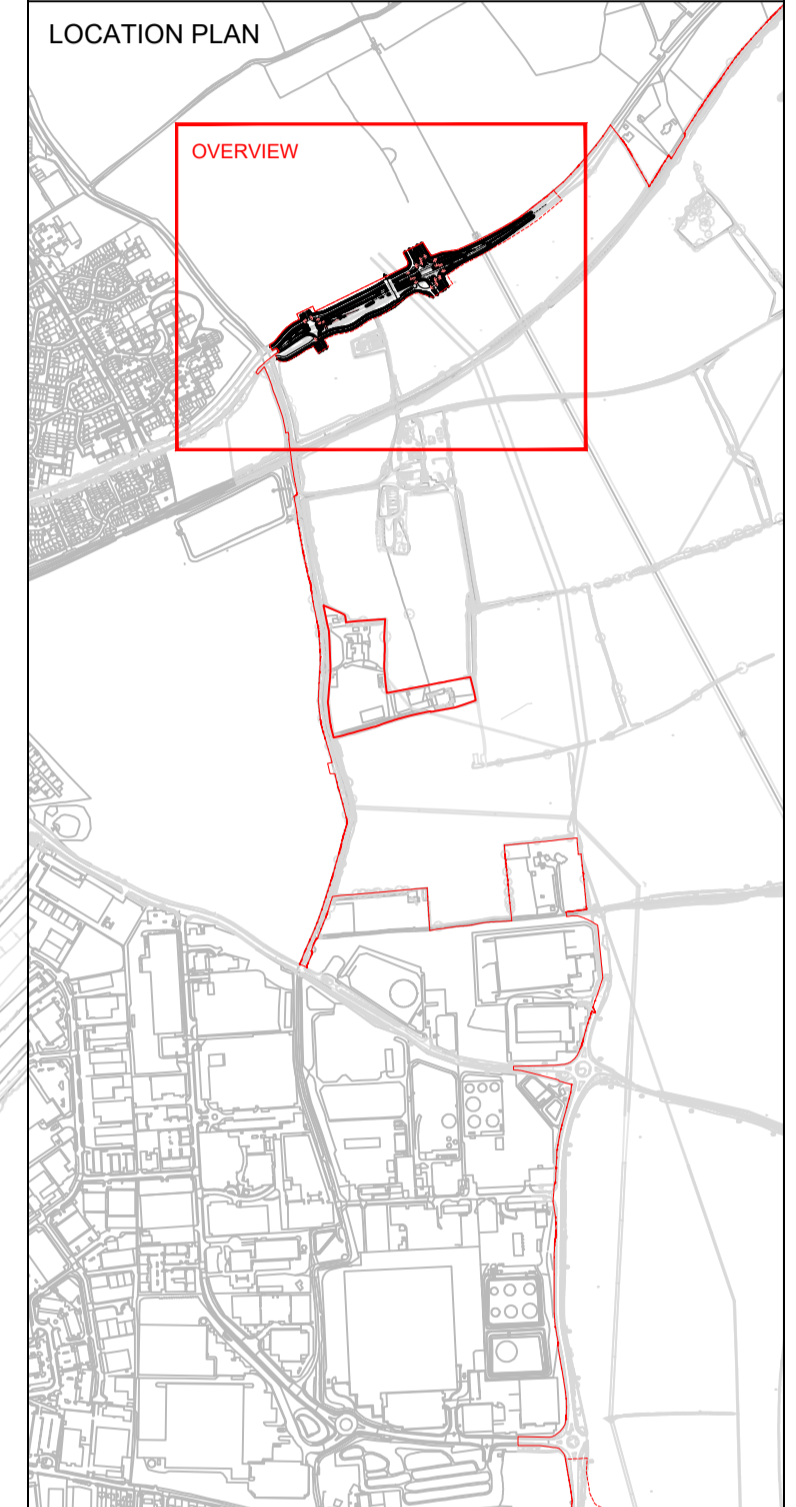

Drawing Status & Suitability Code
FOR PLANNING SUBMISSION S2

Client
THE CROWN ESTATE

Project
EAST HEMEL HEMPSTEAD

Drawing Title
DETAILED PLANNING - REDBOURN ROAD OVERVIEW PLAN

Scale
1:1000 @ A1 SLR Project No. 425.065533.00001

Designed JB	Drawn JB	Checked NL	Authorised AB
Date 02.09.25	Date 02.09.25	Date 02/09/25	Date 02.09.25

Drawing Number
EHUK-VEC-ZZZ-XXX-SK-CR-00082.1

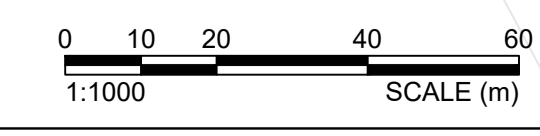

19/11/2025
I:\0652019\WD19103 East Hemel Hempstead Road Planning Application Drawings\EHUK-VEC-ZZZ-XXX-SK-CR-00082.1 - Redbourn Road Overview Plan.dwg